

# CORNER RECORD

PWFB 1431

1323

Document Number

City of Unincorporated

County of Los Angeles, California

Brief Legal Description Lot 79, Tract No. 15436, M.B. 527, Pgs. 36 & 37

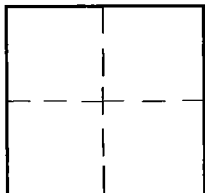

### CORNERTYPE

Govt. Corner  Control   
 Meander  Property   
 Rancho  Other   
 Date of Survey 12/13/2010

### COORDINATES (Optional)

N. \_\_\_\_\_  
 E. \_\_\_\_\_  
 Zone \_\_\_\_\_ NAD27  NAD83   
 NAD83 Epoch \_\_\_\_\_  
 Elev. \_\_\_\_\_  
 Vert. Datum: NGVD29  NAVD88   
 Meas. Units: Metric  Imperial

Corner - Left as found  Found & tagged  Established  Reestablished  Rebuilt

Identification and type of corner found: Evidence used to identify or procedure used to establish or reestablish the corner:

See Sketch

A description of the physical condition of the monument as found and as set or reset:

See Sketch

### SURVEYOR'S STATEMENT

This Corner Record was prepared by me or under my direction in conformance with the Land Surveyors' Act on December 21 2010  
 Signed Mark R. Danielson (P.L.S.) or R.G.E. No. 7082

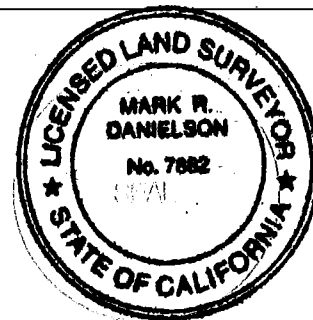

### COUNTY SURVEYOR'S STATEMENT

This Corner Record was received DEC 23 2010  
 and examined and filed JAN 10 2011  
 Signed Curt M. O'Bryan P.L.S. or R.C.E. No. 6388  
 Title: DEPUTY COUNTY SURVEYOR

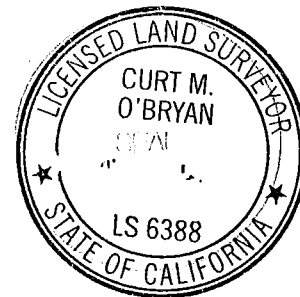

County Surveyor's Comment \_\_\_\_\_

